

## HOW TO ORDER

---

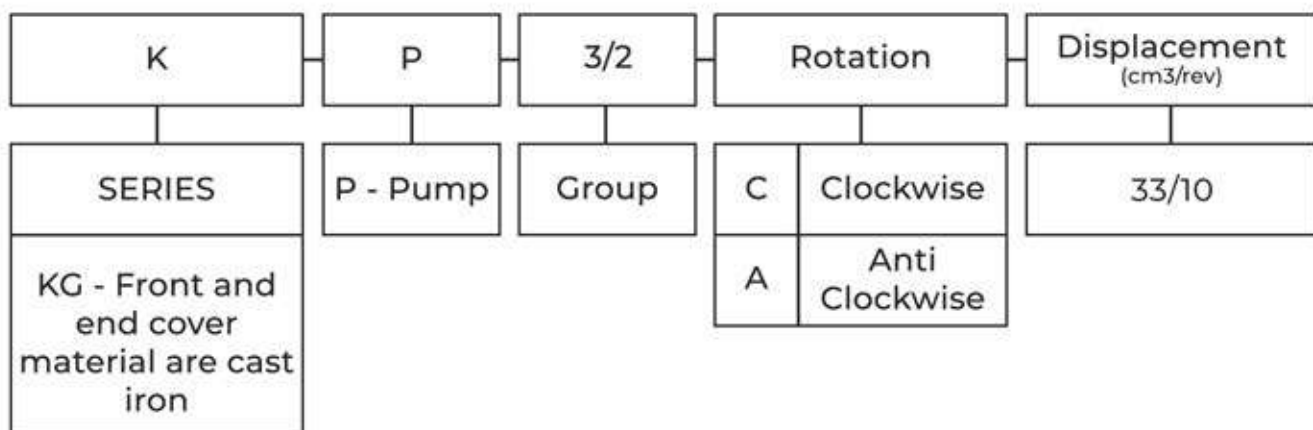

# TECHICAL SHEET

DOUBLE GEAR PUMP GR3 + GR2 TAPERED SHAFT 1:8 - CLOCKWISE



Use axial gap automatic compensation mechanism.

High sustained working pressure and long service life.

Anti fouling ability is strong and suitable for power units, tractors, machines and other kinds of hydraulic systems.

OUTLET

INLET

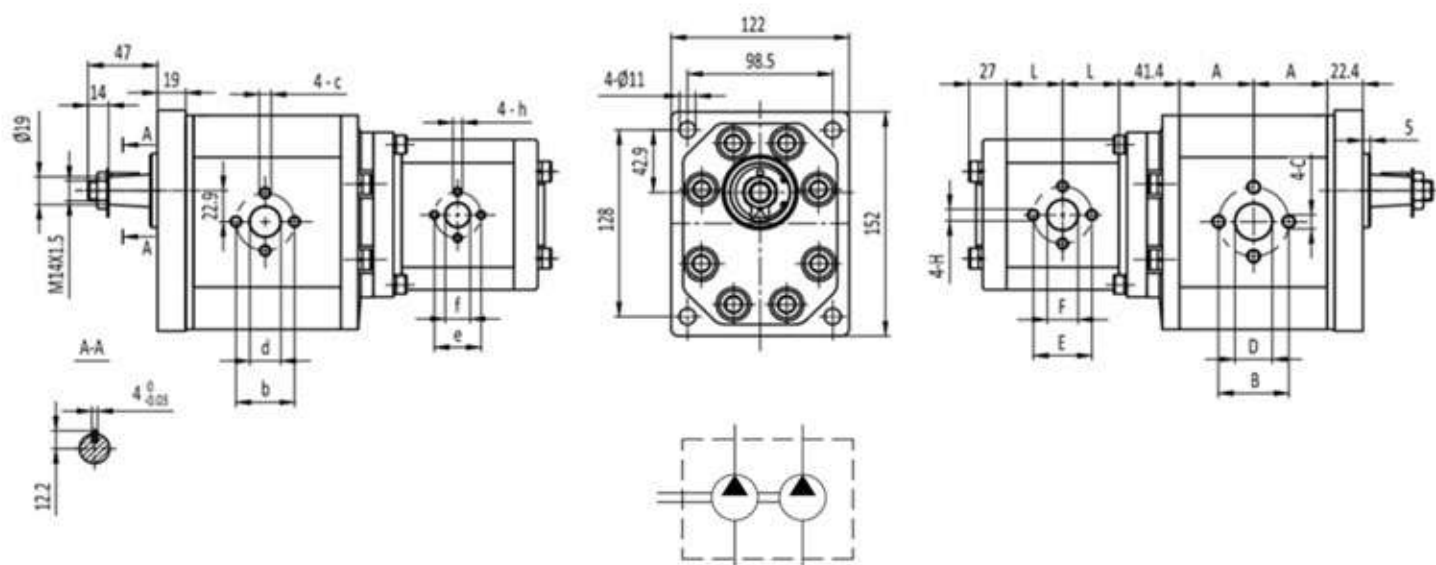

Technical parameter table of front pump

Type	Displacement (cm <sup>3</sup> /rev)	Max. Pressure (bar)			Max. Speed (r/min)	Min. Speed (r/min)	Dimensions (mm)						
		P1	P2	P3			A	B	D	C	b	d	c
KTP32C33 **	33	200	225	250	3000	500	46.1	51	27	M10	40	19	M8
KTP32C46 **	46	200	225	250	3000	500	52.6	51	27	M10	40	19	M8
KTP32C55 **	55	200	230	250	2800	400	56.6	51	27	M10	40	19	M8

Technical parameter table of front pump

Type	Displacement (cm <sup>3</sup> /rev)	Max. Pressure (bar)			Max. Speed (r/min)	Min. Speed (r/min)	Dimensions (mm)						
		P1	P2	P3			L	E	F	H	e	f	h
KTP32C ** 08	8	200	225	250	3000	500	28.7	30	13	M6	30	13	M6
KTP32C ** 10	10	200	225	250	3000	500	30.3	40	20	M8	30	13	M6
KTP32C ** 25	25	200	215	230	2800	400	42.6	40	22	M8	30	13	M6